



SECOND CENTURY CAPITAL CAMPAIGN

Replace Skylight Laylight Complex – Fundraising Goal \$390,000

This year, we kick off the next phase of the Second Century Capital Campaign to replace the skylight system and insulate the perimeter walls and attic spaces in order to improve the building's energy efficiency.

The skylight system is one of the building's most compelling design features, bathing the gallery spaces in natural light. The existing skylight system, however, offers no insulative value in the winter and causes significant heat gain in the summer and heat loss in the winter. Our goal is to preserve the building's historic character while making energy-efficient heating and cooling of the building a reality.

Skylight Replacement — \$230,000: Install new low-profile, sloped insulated glazing system to match historic profile.

Laylight Replacement — \$140,000: Install custom-sized insulated translucent panels. Insulate between panels. Repair and paint gallery-side ceiling laylight frames.

Attic Insulation — \$20,000: Install R38 fiberglass batt insulation in attic ceilings. Construct elevated walkway for attic access to laylight system.

NAMING OPPORTUNITIES

- \$ 250,000 Center Gallery
- \$ 200,000 Entry Foyer Gallery
- \$ 150,000 Art Studio
- \$125,000 Elected Artist Gallery
- \$125,000 Lower Gallery

SPECIAL GIVING LEVELS

- Keep a whole gallery dry: \$50,000
- Keep a whole gallery warm/cool: \$35,000
- Buy a Skylight: \$1,000
- Buy a Laylight: \$500

BUILDING ENDOWMENT: Growing our endowment (currently at \$900,000) to \$1,500,000 or more will ensure ongoing maintenance to preserve and protect our historic property into its second century.

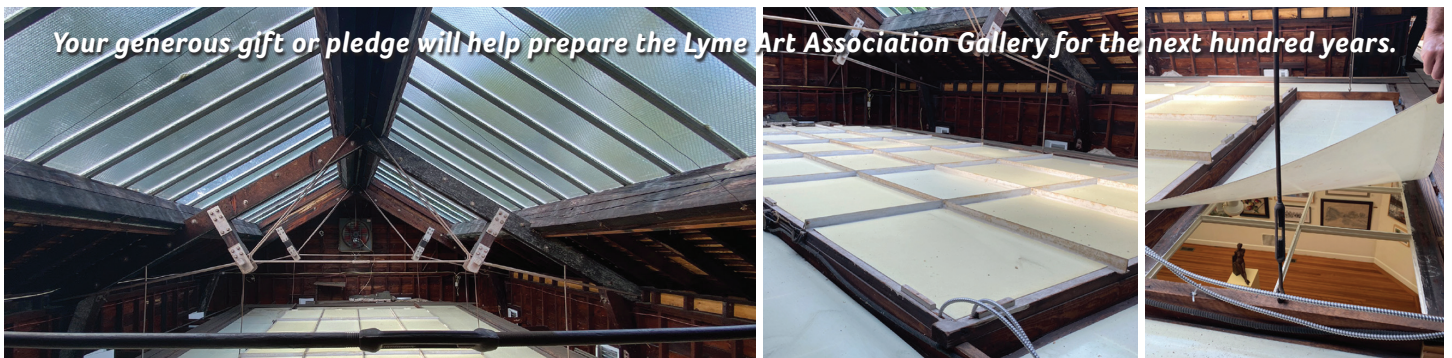
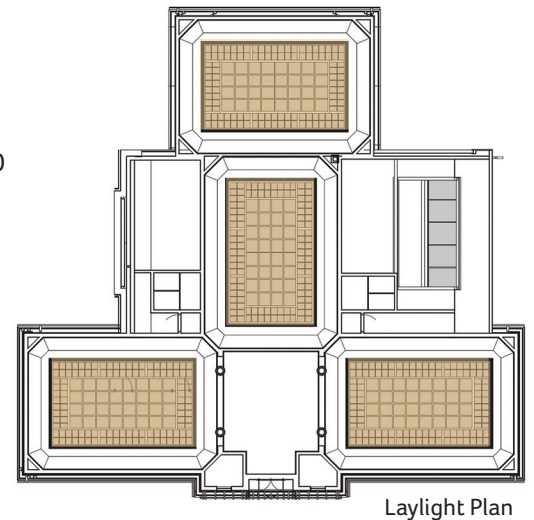
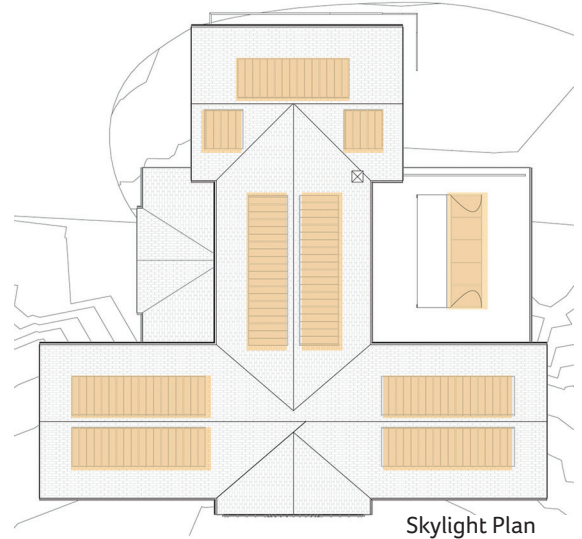

Above: View of attic showing skylights above and laylights below.

Your generous gift or pledge will help prepare the Lyme Art Association Gallery for the next hundred years.